

VALVOIND Srl Via Pascoli, 5 - 24060 Bagnatica (Bergamo) Tel. 035.681919-Fax. 035.684461

Valvoind

valvole industriali

FUNCTIONS:

Supplying compressed air/fluid (minimum pressure difference 2 bar) into the casing of the air operated Pinch Valve compresses the sleeve, which is specially manufactured with high rebound elasticity. The body's design guarantees that the sleeve can close freely to form a lip shape. This ensures that the product flow is completely sealed off tight and that the sleeve is guaranteed the longest service life at the same time. This closes the air operated Pinch Valve and completely seals off the flow of the product.

Maximum pressure used : 2 to 6 bar (depending on valve Ø).

Warning : this valve is not recommended to intercept the fluidsand/or powder below the SILOS, since it is NORMALLY OPEN and there is the risk of emptying It.

Maintenance: Simple and rapid replacement of the rubber sleeve

Application : grinding fluid , corrosive fluid, granulate, powder and sediment.

SLEEVE	temperature	
	operating	max
Nitrile (BUNA)	90°	115°
Butile	90°	115°
EPDM	120°	150°
FKM	150°	180°
Neoprene	90°	110°
Hypalon	100°	120°
natural rubber	65°	90°
rubber food quality	65°	90°

Benefits:

low net weight
Free flow of product,
minimum frictional resistance,
100% leak free,
no blockages

Threaded pinch valve						Pressure fluid bar
Code	G	T mm	SW mm	L mm	DA mm	
VM ...03	3/8"	16	24	122	46	6
VM ...04	1/2"	18	36	134	60	6
VM ...05	3/4"	19	36	140	60	6
VM ...06	1"	20	46	145	75	6
VM ...07	1¼"	25	52	169	85	6
VM ...08	1½"	26	65	200	101	6
VM ...09	2"	24	80	213	120	6

THREADED VALVE	
code	body
VM500..	Alluminium
VM501..	In PVC

FLANGED VALVE	
code	BODY
VM510..	Alluminium
VM511..	S. steel

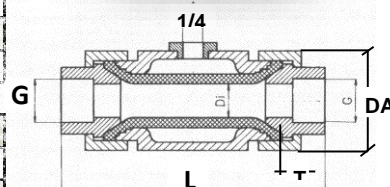

close

open

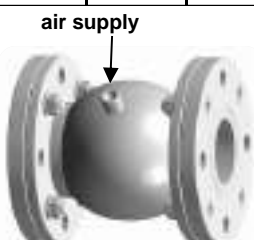
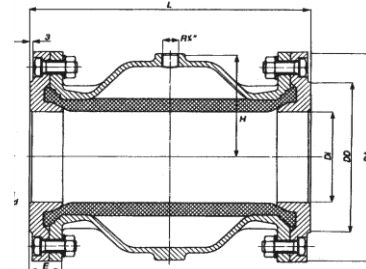
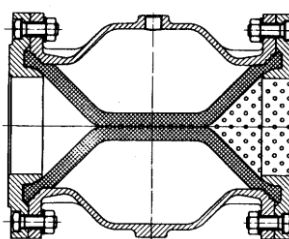

FLANGED PINCH VALVE													Pressure fluid bar
Code	DN (mm)	DI (mm)	DA (mm)	DD (mm)	d (mm)	screw n°	TK (mm)	L (mm)	H (mm)	E (mm)	weight Kg	capacity liter	
VM...08	40	40	150	88	18	4	110	155	63	32	3,2	0,20	6
VM...09	50	50	165	102	18	4	125	183	60	30	3,5	0,25	6
VM...10	65	60	185	122	18	4	145	183	77	32	5,0	0,40	6
VM...11	80	75	200	133	18	8	160	227	89	32	6,0	1,10	6
VM...12	100	100	220	159	18	8	180	281	107	35	8,0	1,30	6
VM...13	125	120	250	184	18	8	210	350	130	39	12,0	2,60	6
VM...14	150	145	286	212	22	8	240	420	156	43	17,0	4,90	6
VM...15	200	190	340	269	22	8	295	555	201	60	35,0	15,00	4
VM...16	250	250	395	320	22	12	350	610	258	49	84,0	30,00	2

VM 102

MANUAL PINCH VALVES

Application : liquids-powder-abrasive granule
 body : alluminium
 control : handwheel
 End Connect : UNI PN 10 flanged
 Temp. max. : 50°C
 working pressure

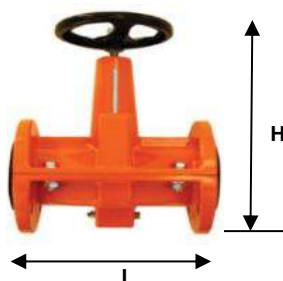

CODE	SLEEVE
VM102..	not abrasive rubber
VM103..	Neoprene
VM104..	FKM
VM105..	Silicon
VM106..	Hypalon

Code	DN	L mm	H mm	pitch circle mm	hole n°	Pressure fluid
VM...04	15	162	195	65	4	5 bar
VM...05	20	162	210	75	4	5 bar
VM...06	25	196	225	85	4	5 bar
VM...07	32	196	250	100	4	5 bar
VM...08	40	216	285	110	4	5 bar
VM...09	50	246	300	125	4	5 bar
VM...10	65	256	445	145	4	5 bar
VM...11	80	276	490	160	4	5 bar
VM...12	100	316	530	180	8	5 bar
VM...13	125	325	970	210	8	3 Bar
VM...14	150	325	790	240	8	3 Bar
VM...15	200	370	850	295	8	3 Bar
VM...16	250	524	1090	350	12	2 Bar

VM 112

SINGLE EFFECT PNEUMATIC PINCH VALVE - NORMALLY CLOSE

CODE	SLEEVE
VM112..	not abrasive rubber
VM113..	Neoprene
VM114..	FKM
VM115..	Silicon
VM116..	Hypalon

Application : liquids-powder-abrasive granule
 Body : alluminium
 Control : S.E. pneumatic
 End Connect : UNI PN 10 flanged
 Temp. max. : 50°C
 working pressure : see schedule

air open	Code	DN	L	H	pitch circl	hole	Pressure
			mm	mm	mm	n°	fluid
	VM...04	15	162	285	65	4	5 bar
	VM...05	20	162	300	75	4	5 bar
	VM...06	25	196	360	85	4	5 bar
	VM...07	32	196	380	100	4	5 bar
	VM...08	40	216	440	110	4	3 bar
	VM...09	50	246	450	125	4	3 bar
	VM...10	65	256	650	145	4	3 bar
	VM...11	80	276	830	160	4	3 bar
	VM...12	100	316	860	180	8	3 bar
	VM...13	125	325	1040	210	8	3 Bar
	VM...14	150	325	1080	240	8	3 Bar
	VM...15	200	370	1200	295	8	3 Bar

VM 122

DOUBLE EFFECT PNEUMATIC PINCH VALVE

CODE	SLEEVE
VM122..	not abrasive rubber
VM123..	Neoprene
VM124..	FKM
VM125..	Silicon
VM126..	Hypalon

Application :
 liquids-powder-abrasive granule
 body : alluminium
 Control : D.E. pneumatic
 End Connect : PN 10 flanged
 Temp. max. : 50°C
 working press. : see schedule

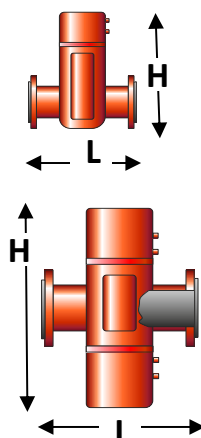

air open	Code	DN	L	H	pitch circl	hole	Pressure
			mm	mm	mm	n°	fluid
	VM...04	15	162	195	65	4	5 bar
	VM...05	20	162	200	75	4	5 bar
	VM...06	25	196	240	85	4	5 bar
	VM...07	32	196	250	100	4	5 bar
	VM...08	40	216	320	110	4	3 bar
	VM...09	50	246	330	125	4	3 bar
	VM...10	65	256	440	145	4	5 bar
	VM...11	80	276	580	160	4	5 bar
	VM...12	100	316	600	180	8	5 bar
	VM...13	125	325	750	210	8	3 Bar
	VM...14	150	325	800	240	8	3 Bar
	VM...15	200	370	920	295	8	3 Bar